



SMOOTHIE KING
CENTER



NEW ORLEANS' FINEST STAGE



Located on the threshold of one of America's most exciting cities, the Smoothie King Center has taken its place as the number one entertainment and sports venue in the region. Adjacent to the iconic Mercedes-Benz Superdome and within close proximity to downtown, the French Quarter, and thousands of first class hotel rooms, the Smoothie King Center is New Orleans' premier facility for a wide variety of events.

With high-end finishes and an array of premium spaces located throughout the facility, the Smoothie King Center is VIP ready. With flexible seating configurations and an upper level curtain system, clients are able to create the ideal intimate setting for any special event or general session. It is a technology driven facility, with numerous LED video boards, including two impressive exterior mega boards, and excellent electrical, lighting and audio capabilities. Its state-of-the-art center-hung HD video screens create an unforgettable, immersive experience. The Smoothie King Center continues to set the standard for arenas across the country.

WORLD-CLASS EVENTS



With its opening in 1999, the Smoothie King Center sparked the continued development of live entertainment throughout the region, and hosts some of the world's largest musical acts and sporting events. The building is home to the NBA Pelicans, and has hosted multiple NBA All-Star Games and NCAA Women's Final Fours. Numerous special events and general sessions have been held with outstanding results, within the same walls where champions have been crowned and world-class performers have thrilled thousands of fans.

EVENTS

- NBA Basketball
- NBA All-Star Games
- NCAA Women's Final Fours
- NCAA Regionals
- Concerts
- Family Shows
- General Sessions
- Special Events

NORTH CLUB



VIP EXPERIENCE

SOUTH CLUB



SUITES



COURTSIDE CLUB



PRIVATE PREMIUM AREAS

NORTH CLUB

- 135 seated, 150 reception / Mezzanine Level, North Side

SOUTH CLUB

- 140 seated, 125 reception / Mezzanine Level, South Side

SUITES

- 56 privately owned luxury suites,
2 large suites / 200 Suite Level

COURTSIDE CLUB

- 100 seated, 200 reception / Ground Level, East Side

CHAIRMAN'S CLUB

- 150 reception / Ground Level, South Side

LOGE BOXES

- 16 boxes / 100 Level, Sections 105-108

HUB CLUB

- 137 fixed seats in arena bowl,
150 reception / 150 Suite Level, West Side

CHAIRMAN'S CLUB



LOGE BOX

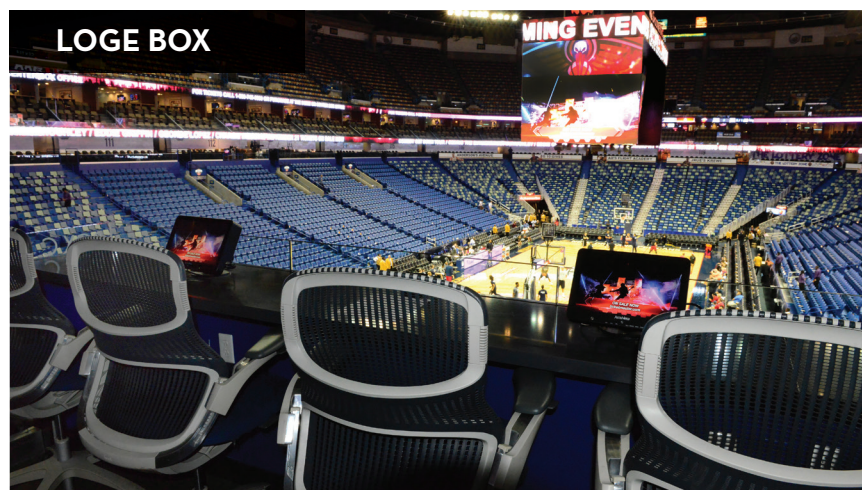

TECHNOLOGY DRIVEN



BOX OFFICE LED BOARD



EXTERIOR LED MEGA BOARD



INTERIOR VIDEO BOARDS

- HD full color LED center-hung board (inner bowl) including:
 - Two video boards: 48' x 21'
 - Two video boards: 25' x 21'
- Two full color 360-degree halo boards (inner bowl)
 - Upper halo board: 19" x 924'
 - Lower halo board: 22" x 871'
- Two full color end wall boards (inner bowl on east and west): 7'2" x 13'2"

EXTERIOR VIDEO BOARDS

- Two mega LED boards (south): 92.38' x 50.39'
- LED box office board (northeast) 162.73' x 6.3'
- LED barco board (northwest): 15'6" x 20'7"

ADDITIONAL AMENITIES

- High speed WIFI throughout facility
- In-house video and CCTV capabilities
- 360 degree upper bowl black curtain drape system



CENTER-HUNG

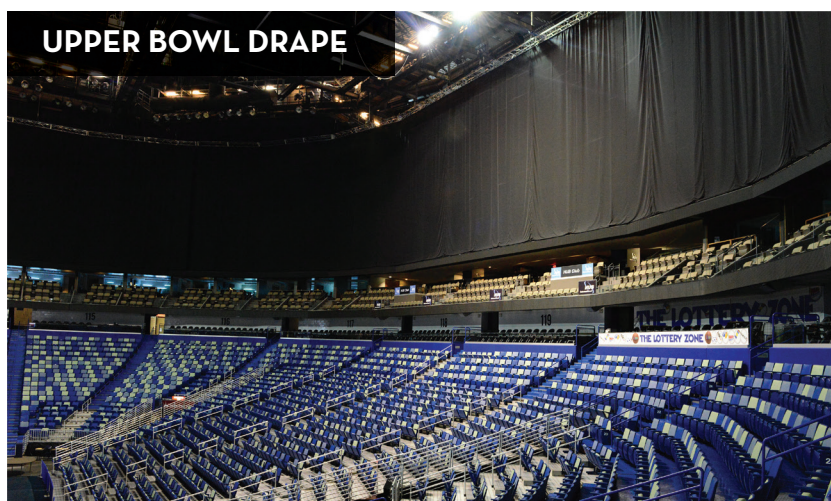

UPPER BOWL DRAPE

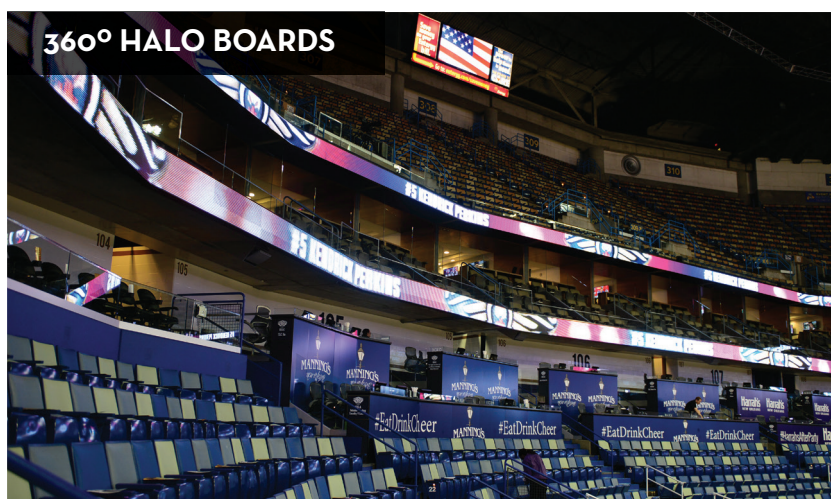

360° HALO BOARDS

FACILITY SPECIFICATIONS



MAIN ARENA FLOOR SPACE

- Basketball configuration: 154' x 85' (13,090 sq. ft.)
- Non-basketball configuration (east and west stands fully retracted): 250' x 85' (21,250 sq. ft.)
- Concert configuration: seating capacities for 180, 270 and 360 degree shows

SEATING CONFIGURATIONS

- Flexible seating up to 17,791, depending on configuration
- ADA seating available on all levels
- Moveable truss for reduced house configurations
- Theatrical configuration: half-house curtain drape
- 90' x 330' in-house curtain drape
- 360 degree upper bowl black curtain drape system

CEILING HEIGHT

- 150' at apex; 100' at perimeter

RIGGING GRID

- 95' 9" from floor level
- Rigging: preferred company allowed to rig from ceiling grid

FLOOR LOAD CAPACITY

- Maximum uniform distributed load of 350 lbs. per sq. ft.

LIGHTING & SOUND

- Broadcast-quality metal halide lighting system with blackout capability
- In-house sound system

ELECTRICAL / IT

- Backstage power: seven separate services totaling 34,000 amps
- TV/production power: five separate services totaling 20,000 amps
- High capacity in-house telephone system capable of handling 1,500+ telephone lines (exclusive)
- High speed internet service: WIFI, DSL, T-1 and DS-3

BACK OF HOUSE & MEETING AREAS

- Total of 14 rooms (dressing, production and locker rooms) various sizes, most restroom equipped
- 2 meeting rooms on ground level

LOADING AREA

- Four-bay loading docks with access to arena floor via 20' x 20' door

PARKING

- 4,600 spaces in adjacent Mercedes-Benz Superdome Parking Garages

- 2,100 spaces in adjacent Champions Garage
- On-site lots for parking/staging of oversized vehicles
- Park and power services available

BOX OFFICE

- Located at North West Ground Entrance
- 16 box office windows

EXCLUSIVES

- Catering and concessions provided by Centerplate
- Medical services & ASM Global event staff
- Merchandise sales
- Certain product, messaging and sponsor signage, and pouring rights apply
- Ticketmaster facility
- In-house telephone and internet services

AMENITIES

- Located within close proximity to many downtown hotels and businesses
- Managed by ASM Global, world leader in private management for public facilities

SEATING CAPACITIES

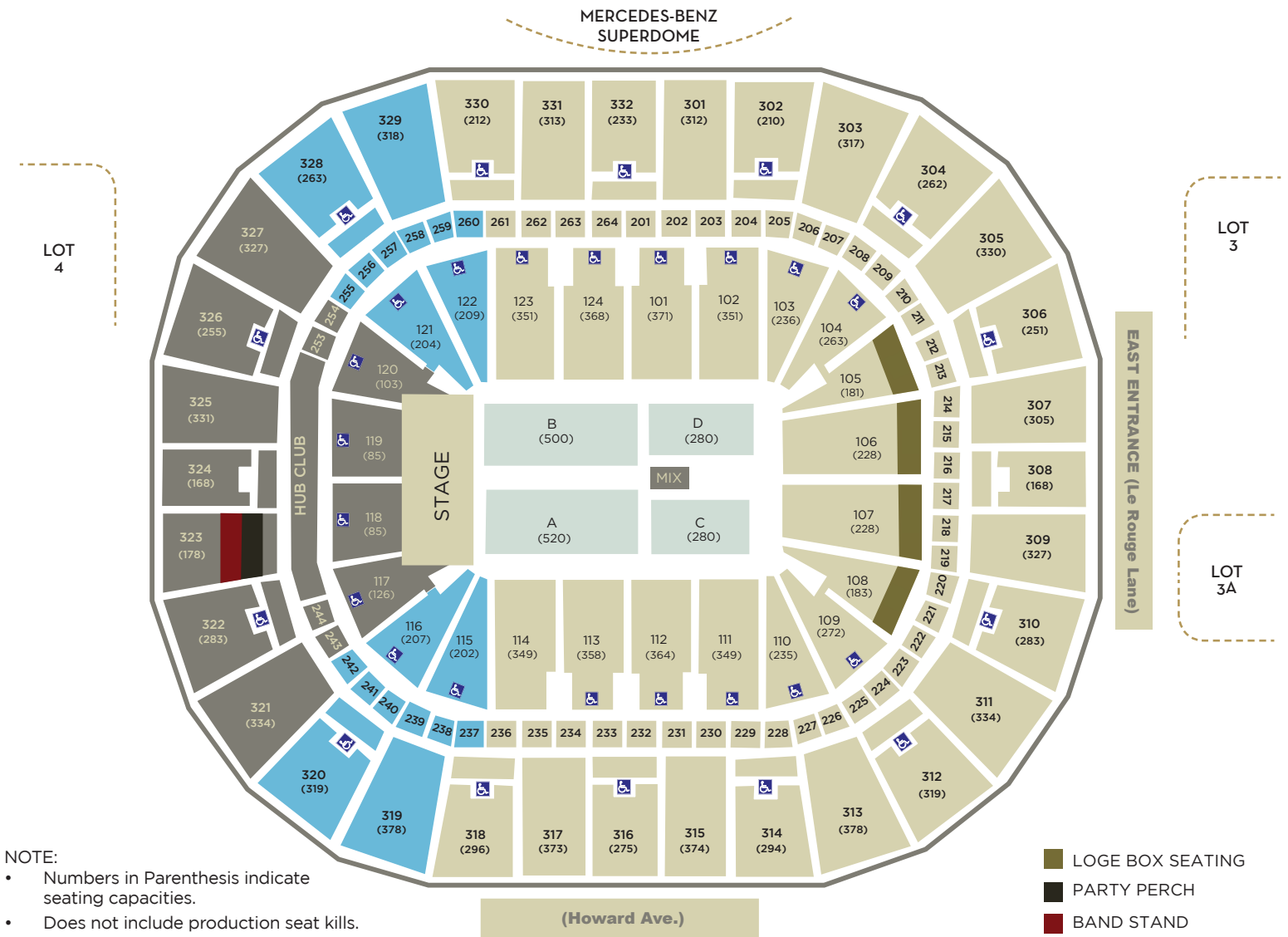

CONFIGURATION	LEVEL	SEATING CAPACITY
360°	FLOOR	1,580*
	100 LEVEL	5,976
	SUITE LEVEL	915
	300 LEVEL	9,320
TOTAL		17,791
270°	FLOOR	1,580*
	100 LEVEL	5,577
	SUITE LEVEL	720
	300 LEVEL	7,444
TOTAL		15,321
180°	FLOOR	1,580*
	100 LEVEL	4,755
	SUITE LEVEL	576
	300 LEVEL	6,166
TOTAL		13,077

*Depending on production requirements seating capacity may vary for the floor level



WHERE THE PERFORMANCE NEVER ENDS

THE COMPLEX

In addition to the Smoothie King Center, ASM Global manages the 76,000 seat Mercedes-Benz Superdome and Champions Square, a more than 90,000 square foot outdoor plaza. All three buildings are located in one central campus, just steps away from each other.

BUILDING MANAGEMENT

ASM Global was formed from the merger of AEG Facilities and SMG in October 2019 creating a venue management powerhouse that spans five continents, 14 countries and more than 300 of the world's most prestigious arenas, stadiums, convention and exhibit centers, and performing arts venues.

BACK OF HOUSE

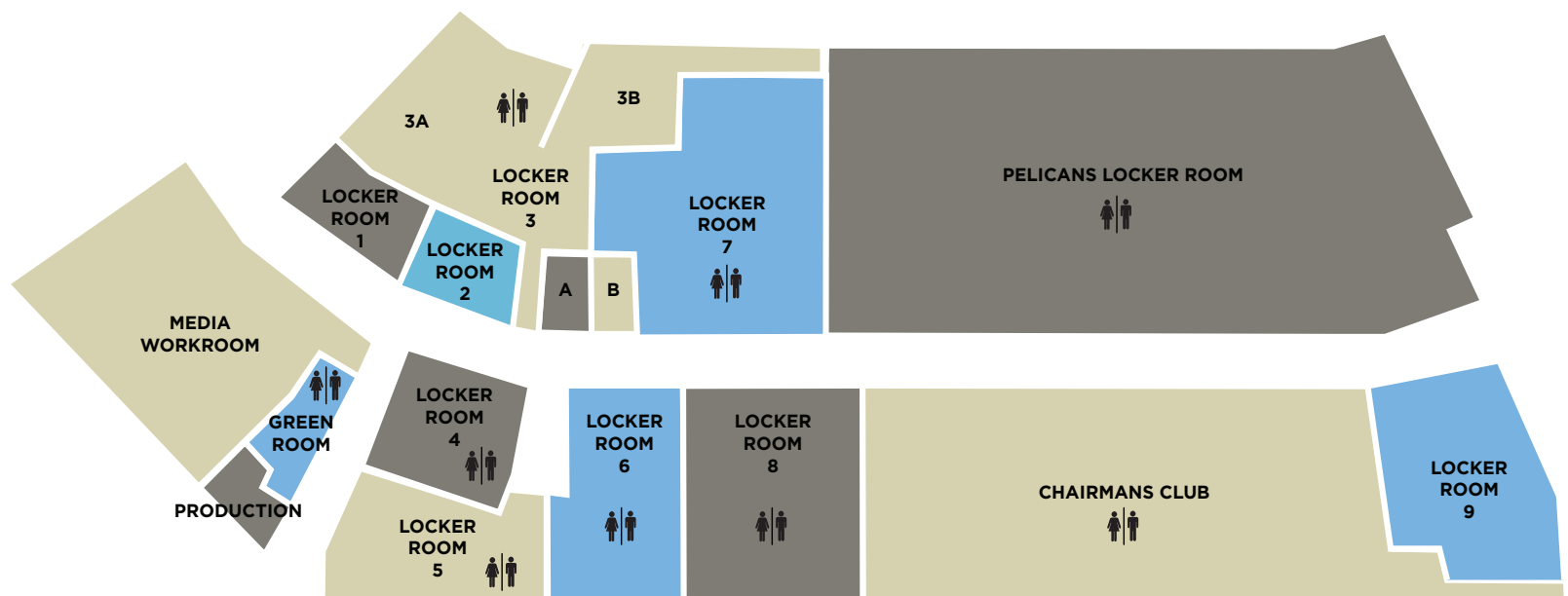

NOTE:

Pelicans Locker Room is exclusive to the NBA Pelicans Team.

The Chairman's Club is subject to limited availability.





SMOOTHIE KING CENTER

1501 Dave Dixon, New Orleans, Louisiana 70113

phone: 504.587.3663 or 800.756.7074 | **fax:** 504.587.3848

email: SKCenterSales@asmneworleans.com

website: www.smoothiekingcenter.com